

1st stage a-102

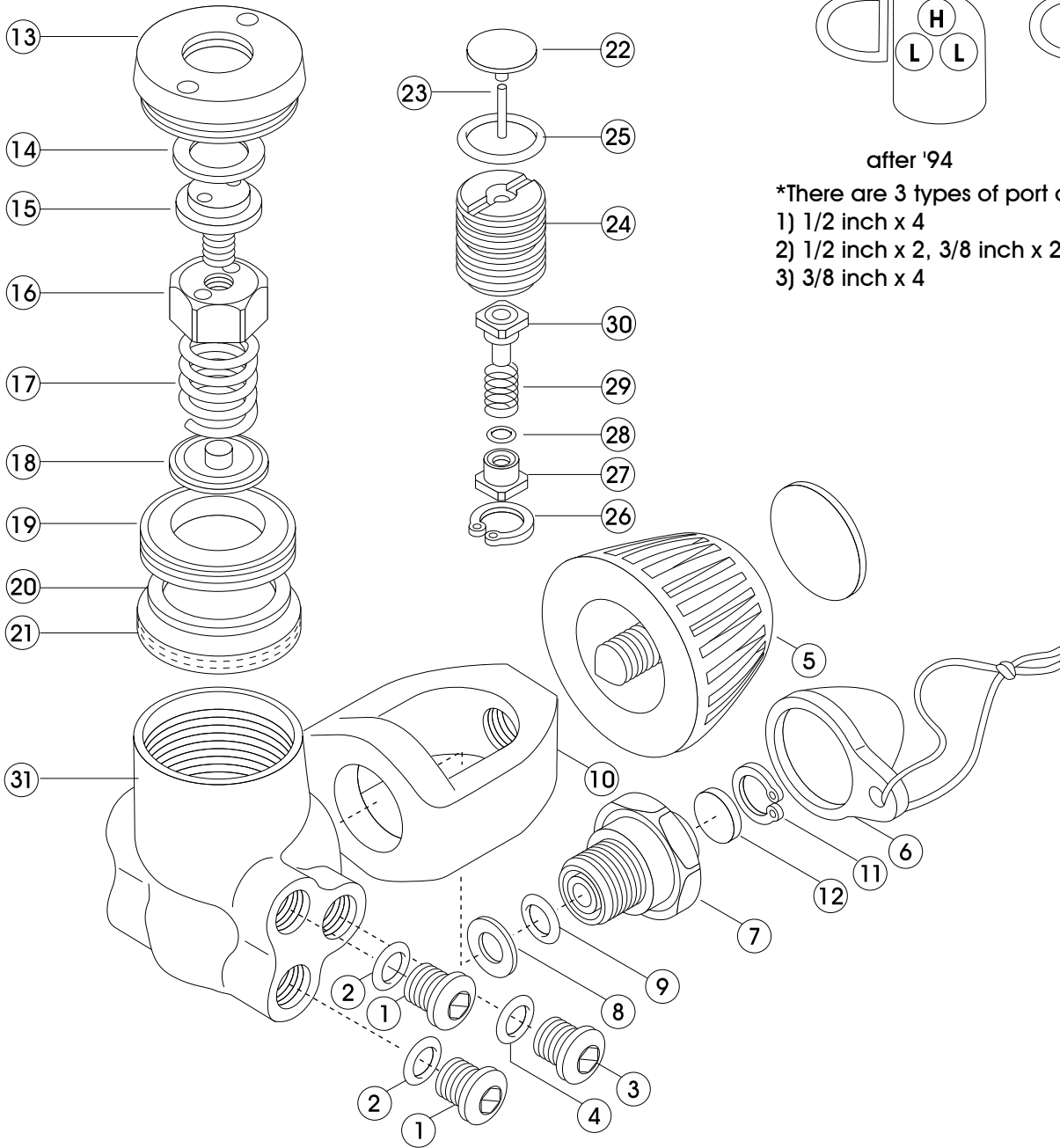

No.	Code	Description
1a	3100101101	PLUG (A) : 3/8 FOR L.P.
1b	3100101904	PORT PLUG, 1/2 FOR REGULATER
2a	3993592011	O-RING ARP-011/HS75
2b	3993592013	O-RING ARP-013/HS75
3	3100101903	PORT PLUG, 7/16 FOR H.P. PORT
4	3993898012	O-RING ARP-012/HS90 ID9.25 VITON
5	2102080158	YOKE SCREW W/DECAL
6	1184380003	DUST CAP ASSY
7	3100101106	YOKE RETAINER : A-102/108/320
8	3990900100	WASHER A-102
9	3993898011	O-RING ARP-011/HS90 ID7.65 VITON
10	3101001032	YOKE FOR PRESTIGE (L)
11	3990500101	RETAINING RING
12	3990800411	FILTER 150 MICRON :SUS316 D/12.6 T/1.66
13	3100201044	BODY CAP 102
14	3102470303	TEFLON WASHER FOR REGULATER
15	3100201043	ADJUSTING SCREW FOR REGULATER
16	3100203047	GUIDE NUT FOR REGULATER

No.	Code	Description
17	3101200062	ADJUST SPRING FOR L.P.:FOR REGULATOR
18	3100101111	SPRING PAD : FOR A-101,2,5,7,8,10,320
19	3100203046	DIAPHRAGM RETAINER FOR REGULATOR
20	3102480001	DIAPHRAGM WASHER PET
21	3103980105	HIGH PRESSURE DIAPHRAGM
22	3100101105	PUSH ROD PAD : FOR A-101,2,5,7,8,10
23	3990100072	PUSH ROD PIN : A-101,2,5,7,8,10
24	3100101115	H.P. MODULE WITH GUIDE SPEC FOR REGULATER
25	3993898017	O-RING ARP-017/HS90 ID17.17 VITON
26	3990500101	RETAINING RING
27	2100100050	BALANCE CHAMBER WITH O-RING: A-101,2,5,7,8,10,20
28	3993898006	O-RING ARP-006/HS90 ID2.90 VITON
29	3101200071	HIGH PRESSURE SPRING : A-101,2,5,7,8,10,320
30	3100103210	PTMEG 2000 HIGH PRESSURE SEAT
31a	3101001031	BODY A-1023 FOR REGULATER
31b	3101001027	BODY A-102
31c	3101001022	BODY